

eCube Plant DNA Mini Kit

**\* Things to do before starting**

1. Preheat a water bath or a heat block bath to 65°C before the operation.
2. For 50preps, add 30ml ethanol to XPPG 3 Buffer, 8ml ethanol to Wash Buffer 1 and 40ml ethanol to Wash Buffer 2.  
For 200preps, add 120ml ethanol to XPPG 3 Buffer, 32ml ethanol to Wash Buffer 1 and 160ml ethanol to Wash Buffer 2.  
For 300preps, add 180ml ethanol to XPPG 3 Buffer, 48ml ethanol to Wash Buffer 1 and 240ml ethanol to Wash Buffer 2.  
\* You have to use 96-100% ethanol.
3. All centrifuge steps are done at **13,000 rpm** in a microcentrifuge.

eCube Plant DNA Mini Kit

**\* Things to do before starting**

1. Preheat a water bath or a heat block bath to 65°C before the operation.
2. For 50preps, add 30ml ethanol to XPPG 3 Buffer, 8ml ethanol to Wash Buffer 1 and 40ml ethanol to Wash Buffer 2.  
For 200preps, add 120ml ethanol to XPPG 3 Buffer, 32ml ethanol to Wash Buffer 1 and 160ml ethanol to Wash Buffer 2.  
For 300preps, add 180ml ethanol to XPPG 3 Buffer, 48ml ethanol to Wash Buffer 1 and 240ml ethanol to Wash Buffer 2.  
\* You have to use 96-100% ethanol.
3. All centrifuge steps are done at **13,000 rpm** in a microcentrifuge.

**Grind the Plant Sample  
(up to 100mg)**

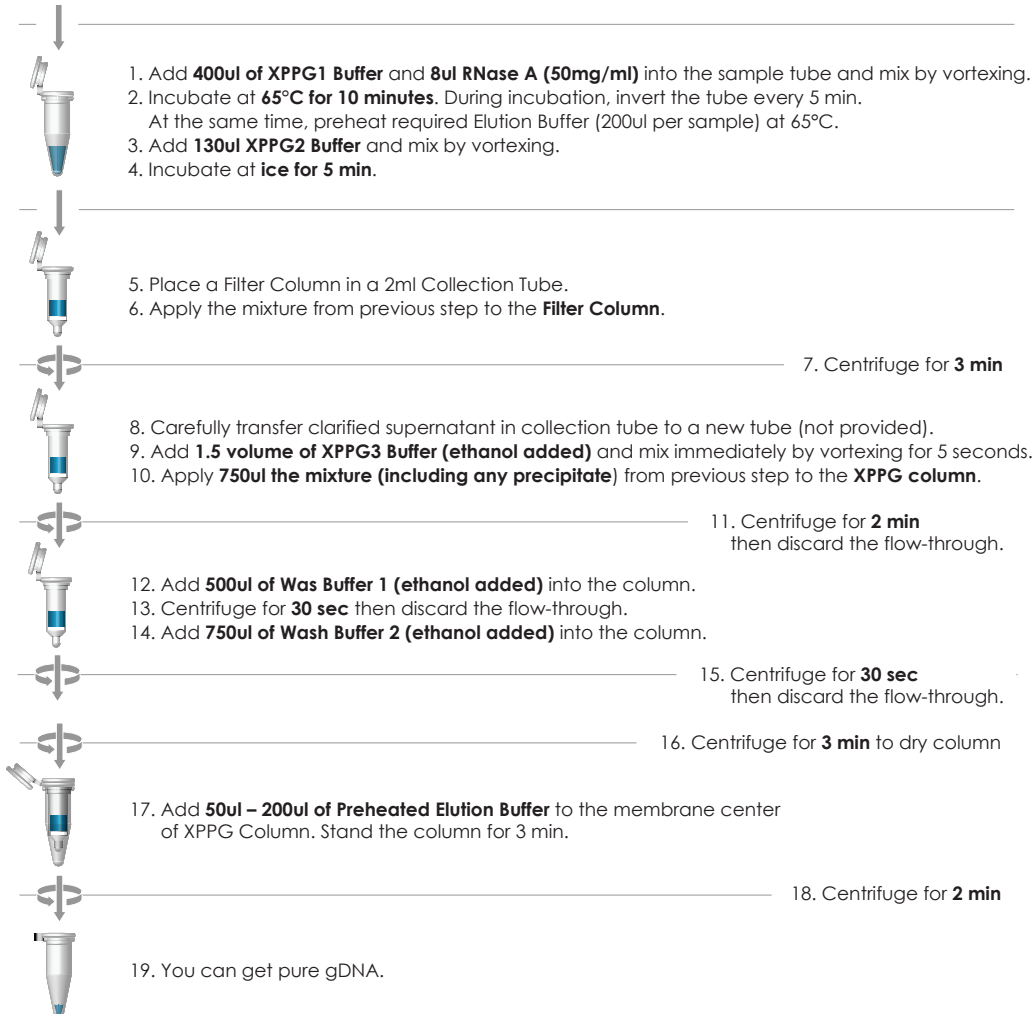

**Grind the Plant Sample  
(up to 100mg)**

